

Original Pipet-Aid®

- Available with or without EZ Grip TC filter nosepiece
- Available with dual pump filtration unit for use with biohazardous materials
- Can be used with glass or plastic pipets
- Autoclavable components



The Drummond Pipet-Aid set the standard for a convenient alternative to mouth pipetting in the laboratory. A patented, easy-to-use volume control mechanism permits precise fluid intake and delivery.

A check valve protects against accidental fluid intake into the handle and optional Tissue Culture Nosepiece will prevent cross-contamination due to over-pipetting. A special filtration unit for use with biohazardous materials is also available.

Cat. No.	Description
4-000-110	Pipet-Aid, Plain, 110V
4-000-111	Pipet-Aid, with Dual Pump Filtration Unit, 110V
4-000-110-TC	Pipet-Aid complete with TC Nosepiece and four extra Filters, 110V
4-000-111-TC	Same as above but with Dual Pump Filtration Unit, 110V
4-000-220	Pipet-Aid, Plain, 220V, CE, Euro
4-000-221	Pipet-Aid, with Dual Pump Filtration Unit, 220V, CE, Euro
4-000-220-TC	Pipet-Aid complete with TC Nosepiece and four extra Filters, 220V, CE, Euro
4-000-221-TC	Same as above but with Dual Pump Filtration Unit, 220V, CE, Euro

U.S. Patent Number: 4,624,147

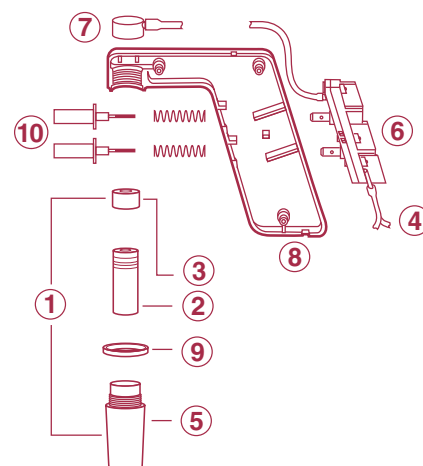

Pipet-Aid Replacement Parts

Cat. No.		Description
4-000-001	(1)	Standard Nosepiece, Complete
4-000-002	(2)	Rubber Insert (2/pk)
4-000-003	(3)	Check Valve Assembly
4-000-004	(4)	Hose (5')
4-000-005		Filter Adapter Kit
4-000-006		Complete Handle Assembly
4-000-007		Complete Pump 110V
4-000-008		Internal Parts Kit with Hose
4-000-009	(5)	Pipet Holder Outer Shell only
4-000-010		Diaphragm Kit for Pump
4-000-011		Hose Connectors (pair)
4-000-012-W	(6)	Valve Body only
4-000-013	(7)	Handle Connector
4-000-014		Complete Pump 220V
4-000-015		Vacuum Valve Housing for Pump
4-000-016		Pressure Valve Housing for Pump
4-000-017	(8)	Handle Shell only
4-000-018	(9)	Nose Ring
4-000-019	(10)	Button Assembly with springs (pair)
4-000-050		EZ Grip TC Nosepiece Complete Kit (see page 3)
4-000-051/051-S		Self-locking TC Filter 5/pk (051-S - Sterile)
4-000-052/052-S		Self-locking TC Filter 50/pk (052-S - Sterile)
4-000-053-A		EZ Grip TC Nosepiece Outer Shell only
4-000-060		Dual Pump Filters (pair)
4-000-089		Pipet-Aid Holster-Type Wall Bracket

Pipet-Aid® Dual Pump Filtration Unit

For use in a biohazardous environment, a filtration unit can be installed on the Pipet-Aid pump which will filter both vacuum and pressure lines. Incorporating dual filters, the Pipet-Aid Biohazard Filter Kit has a retention efficiency of 99.9999+% for 0.1 micron particles and droplets.

Normally factory installed, the Filter Adapter Kit can be attached to existing unfiltered Pipet-Aid pumps.

Cat. No.	Description
4-000-005	Filter Adapter Kit
4-000-060	Dual Pump Filters (pair)

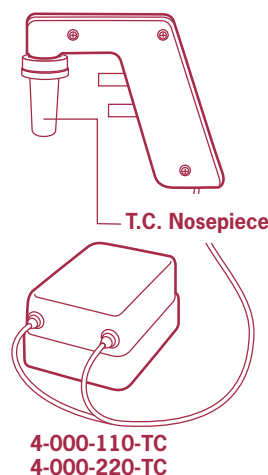

Single Pump Unit

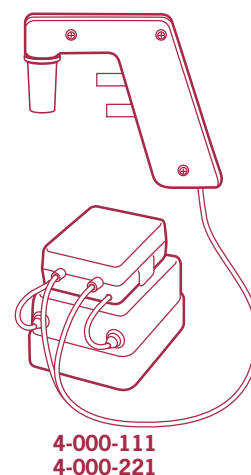

Dual Pump Filtration Unit
(Replacement Filter No. 4-000-060)

Distribuito da: